

Welcome to

Dundee Science Centre

On arrival

A member of the team will meet you at reception and carry out a briefing session for teachers and pupils. If you have more than one class, we may do this in your groups. There will be a place for coats and bags but we suggest not bringing a lot of items as storage space is limited.

Lunch & Snacks

Please wait for a staff member to direct you to your lunch space. You will have 30 minutes for lunch, please be ready to move on at that time.

Unfortunately, we cannot offer time for snacks during your visit.

Gift shop

Only 8 pupils are allowed in the gift shop at one time and they must be accompanied by an adult.

We recommend visiting the gift shop in small groups during your time on the exhibition floor, not leaving it until the end of your visit.

Facilities

- Toilets are located beside Cafe Create.
- The changing places toilet is located to the rear of the centre, please ask a member of staff if you require access to this.
- If the fire alarm goes off, please make your way to one of the exits.
- The first aid room is located beside the gift shop. We also have quiet spaces available. Please let a member of staff know if you require either of these spaces.

Zones

There are 5 main zones throughout the Centre for you to explore.

1. We are Inventing

This zone allows you to practise your skills in designing, making, and tinkering.

2. Brilliant Brain

This zone features exhibits that demonstrate how our brain works with our senses to inform us about the world around us.

3. We are Discovering

These exhibits focus on the world around us, looking at things like the landscape, atmosphere, and micro-organisms.

4. We are Exploring

Exhibits here are created with our younger visitors in mind, but everyone is welcome to get stuck in! Here, play is the focus, with lots of things to explore.

Zones cont.

5. Medical Marvels

This zone showcases local medical research and innovations and demonstrates them with fun, interactive, hands-on exhibits. Keep an eye out for Teddy Bear Hospital too!

Sensory Zone

This area provides a broad sensory experience for visitors and is designed to be a safe and engaging space.

Visit guidelines

Our Formal Learning team have been trained in basic classroom management. However, they look to the class teacher to take overall charge of the group and deal with any serious misbehaviour.

In the case of serious behaviour problems (if pupils' behaviour poses a threat to their own and others' safety and enjoyment of the centre) Dundee Science Centre reserves the right to ask pupils, accompanied by a teacher, to leave the centre.

Children must be supervised at all times.

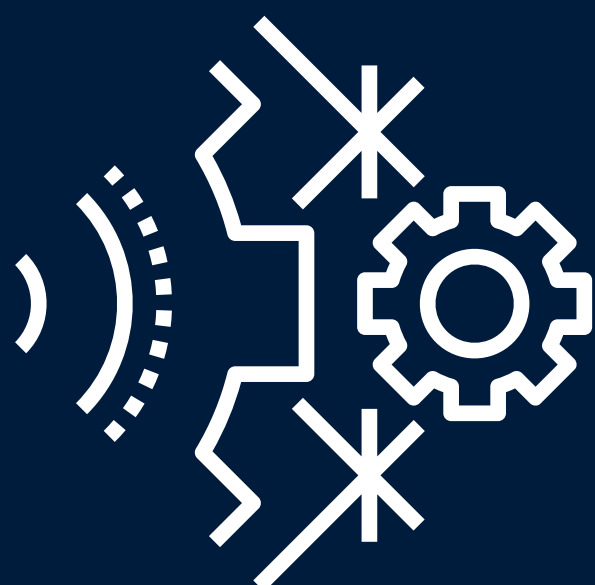

Downstairs

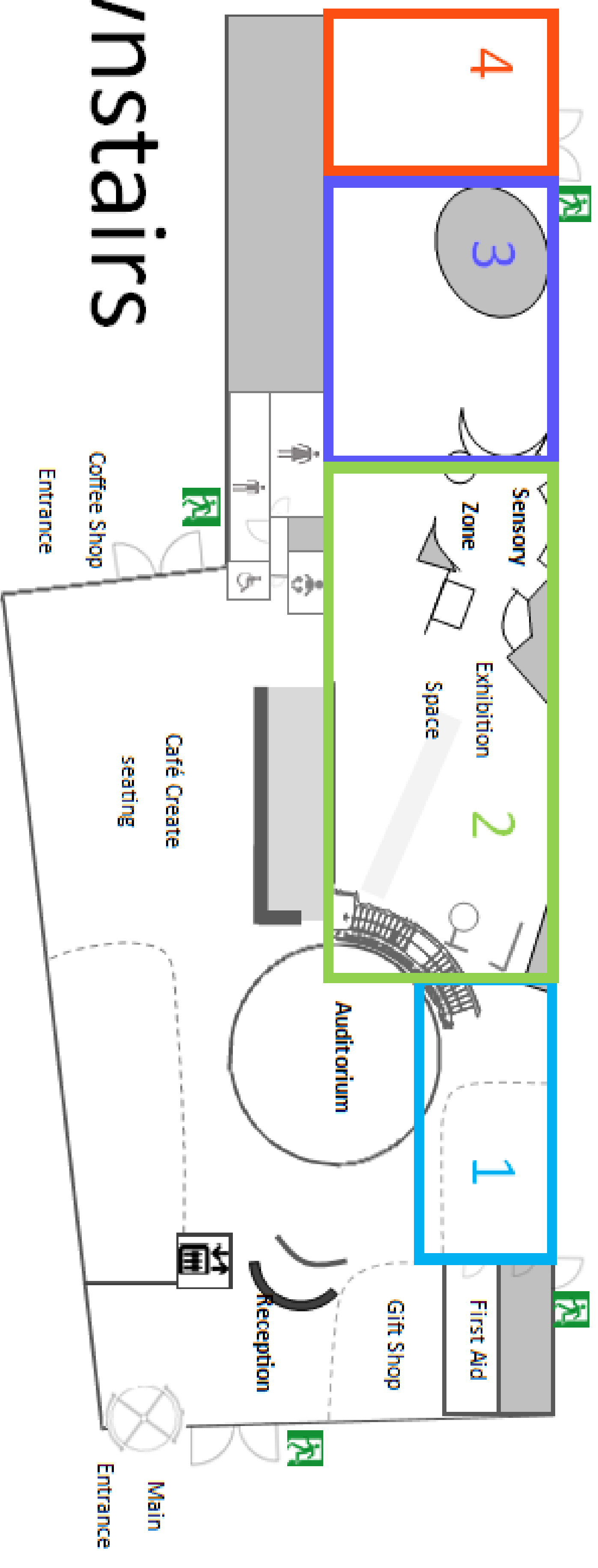

Upstairs

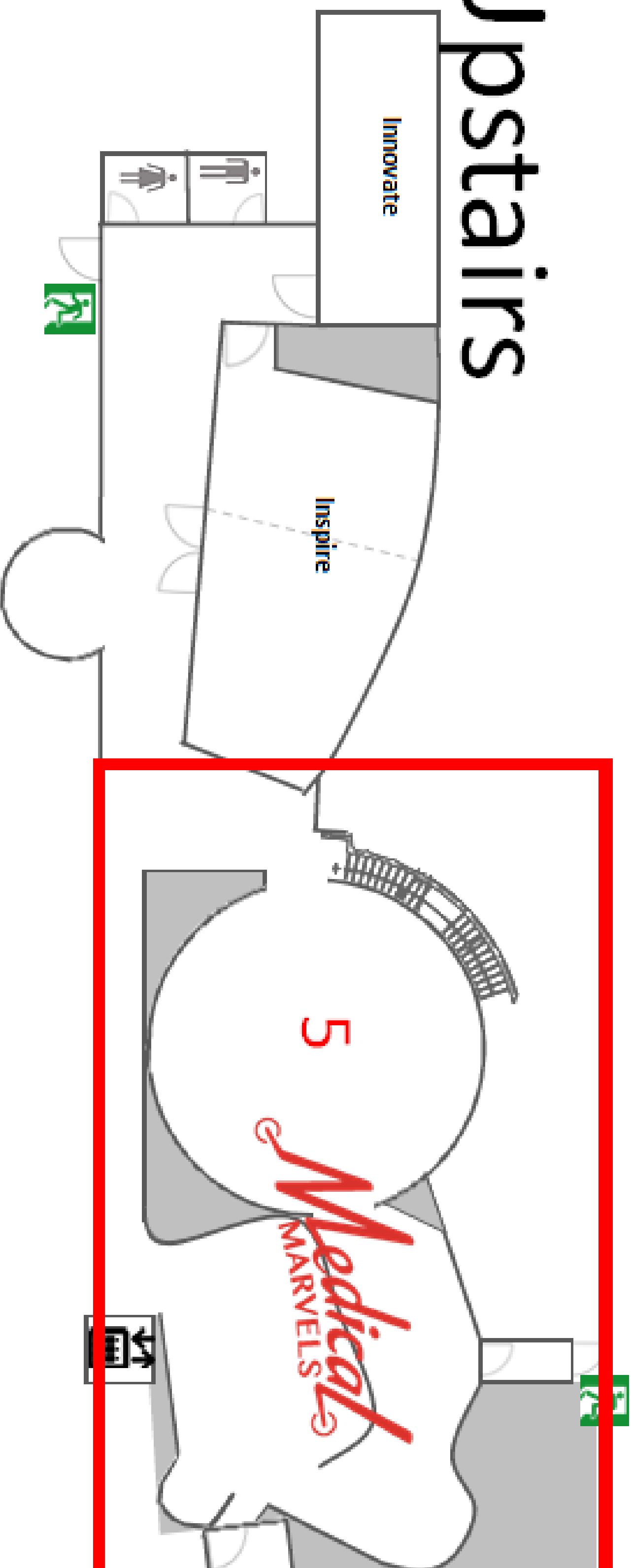

Zone 1: We are inventing

Zone 2: Secret sight &
Brilliant brain

Zone 3: We are discovering

Zone 4: We are exploring

Zone 5: Medical marvels