

Dundee Science Centre

School Visit Teacher Information

On arrival

A member of our Science Communicator team will meet you at reception, and will carry out a briefing session for you and your students. If you have more than one class, we may do this in your groups. There will be coat racks for coats and bags, but we suggest not bringing a lot of items as storage space is limited.

Lunch

If you have prebooked lunch space, a staff member will direct you to your lunch area at the allotted time. You will have 30 minutes for lunch - please be ready to move on at that time.

Gift Shop

Only 10 pupils are allowed in the gift shop at any one time and they must be accompanied by an adult.



Facilities

- There are toilets located on both floors of the Dundee Science Centre; the downstairs toilets are located beside Café Create and the upstairs toilets are located by our Inspire classroom.
- The changing places toilet is located in the *We Are Discovering* zone, please ask a member of staff if you require directions and access to this.
- If the fire alarm goes off, please make your way to one of the fire exits.
- The first aid room is located beside the gift shop - if there is a first aid incident, please let a member of staff know.
- We also have a private/quiet space available - this is located in the *We Are Exploring* zone. Please let a member of staff know if you require this space.

Additional Support Needs

At Dundee Science Centre, we are dedicated to offering inclusive opportunities for all. Our friendly team are always on hand to provide assistance and to offer support for the varying needs of all visitors. Please do let us know when booking or on arrival if any of your pupils have additional support needs so that we can facilitate your visit the best we can.



Exhibition Zones

There are 5 main zones throughout the Centre for your class to explore;

1. We are Inventing

This zone allows visitors to practice their skills in designing, making, and tinkering.

2. Brilliant Brain

This zone features exhibits that demonstrate how our brain works with our senses to inform us about the world we live in.

3. We are Discovering

These exhibits focus on the world around us, looking at things like the landscape, atmosphere, and micro-organisms.

4. We are Exploring

Exhibits here are created with our younger visitors in mind, but everyone is welcome to get stuck in! Here, play is the focus, with lots of things to explore.

5. Medical Marvels

This zone showcases local medical research and innovations and demonstrates them with fun, interactive, hands-on exhibits.



Sensory Zone

We also have a sensory zone, which provides a broad sensory experience for visitors and is designed to be a safe and engaging space.

Visit Guidelines

Our Science Communicators have been trained in basic classroom management. However, they look to the class teacher to take overall charge of the group and deal with any serious misbehaviour.

In the case of serious behaviour problems (if pupils' behaviour poses a threat to their own and others' safety) Dundee Science Centre reserves the right to ask pupils, accompanied by a teacher, to leave the centre.

Children must be supervised by a responsible adult at all times.

We hope you have a fantastic visit!



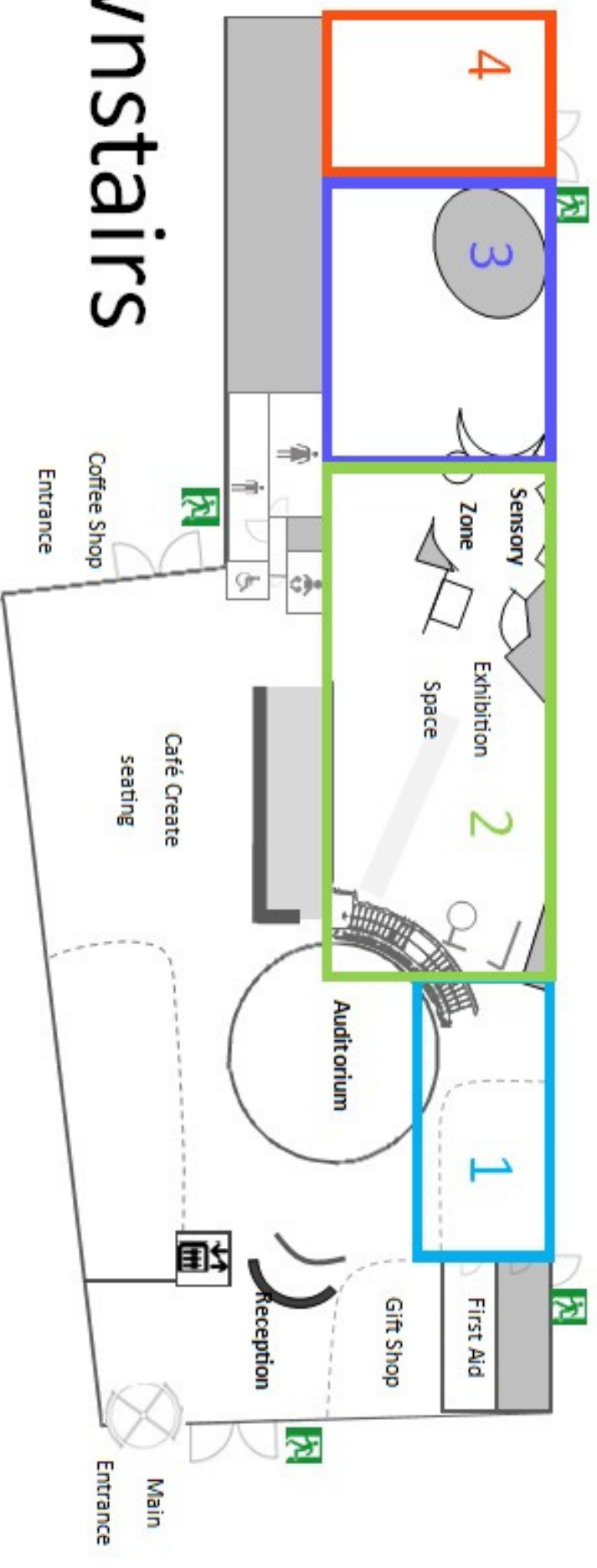

Downstairs

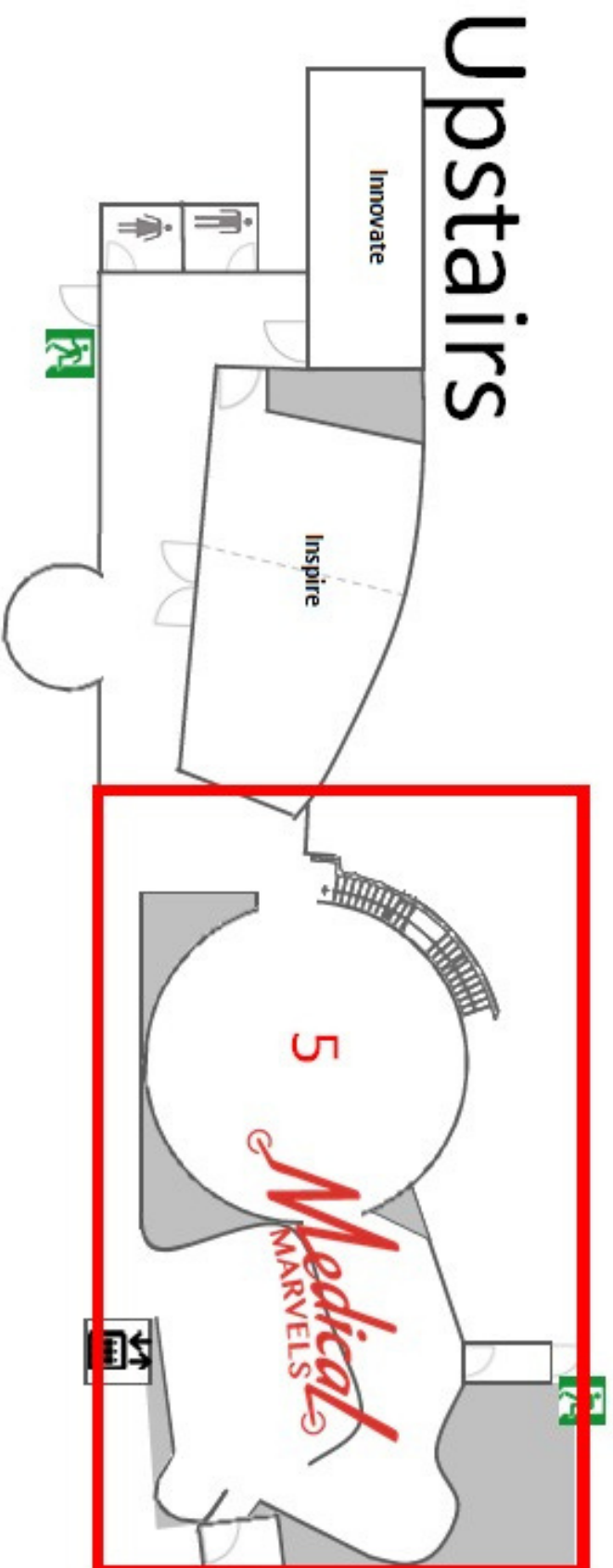

Upstairs

- Zone 1: We are inventing
- Zone 2: Secret sight & Brilliant brain
- Zone 3: We are discovering
- Zone 4: We are exploring
- Zone 5: Medical marvels